

Round Bars Rods

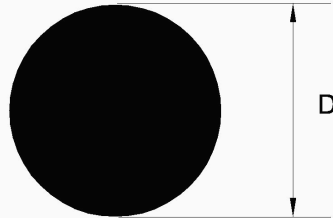

Die Number	Dim. (D)	WT. (LBS/FT)	WT. (KGS/MT)	Toronto	Ohio
S-5706	0.312	0.090	0.134	✓	✓
S-2333	0.375	0.130	0.193	*	*
S-7766	0.438	0.178	0.265	✓	*
S-2162	0.500	0.231	0.344	✓	*
S-16303	0.562	0.293	0.436	✓	
S-3651	0.625	0.362	0.539	*	*
S-21809	0.687	0.437	0.651		*
S-24767	0.687	0.437	0.651	✓	
S-4758	0.750	0.522	0.776	✓	*
S-2632	0.775	0.557	0.829	✓	
S-3652	0.812	0.611	0.909	✓	*
S-22032	0.840	0.654	0.973		✓
S-4771	0.875	0.709	1.055	✓	
S-9515	0.875	0.709	1.055	*	*
S-9514	0.938	0.814	1.212	✓	
S-6980	0.995	0.918	1.366	*	
S-2845	1.000	0.926	1.378	✓	
S-9599	1.000	0.926	1.378	*	*
S-12193	1.062	1.045	1.556		*
S-4772	1.125	1.173	1.745	✓	*
S-13376	1.125	1.173	1.745	*	
S-8958	1.188	1.307	1.946	✓	
S-2187	1.250	1.448	2.155	*	*
S-17999	1.313	1.598	2.378	✓	
S-4759	1.375	1.751	2.606	*	*
S-26465	1.385	1.778	2.646		✓
S-29039	1.438	1.916	2.852	✓	
S-3653	1.460	1.975	2.939	✓	
S-2500	1.500	2.085	3.102	✓	*
S-30934	1.500	2.085	3.103	*	
S-11049	1.562	2.261	3.365	*	*

Round Bars Rods

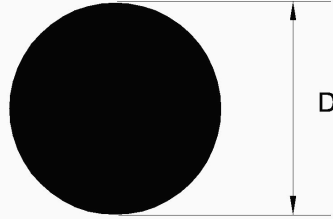

Die Number	Dim. (D)	WT. (LBS/FT)	WT. (KGS/MT)	Toronto	Ohio
S-6851	1.625	2.447	3.642	✓	*
S-26466	1.725	2.758	4.104		✓
S-4760	1.750	2.838	4.223	*	*
S-12194	1.812	3.043	4.528	*	*
S-4761	1.875	3.258	4.848	✓	*
S-4663	2.000	3.708	5.518	*	*
S-9257	2.125	4.185	6.229	✓	*
S-4762	2.250	4.692	6.982	*	*
S-26904	2.375	5.228	7.779		*
S-26467	2.425	5.450	8.110		✓
S-26750	2.438	5.509	8.198		*
S-4856	2.500	5.793	8.620	*	*
S-21376	2.625	6.386	9.503		✓
S-4664	2.750	7.008	10.430	*	*
S-11048	2.875	7.660	11.400	*	
S-4665	3.000	8.341	12.410	✓	*
S-12344	3.063	8.692	12.935		*
S-12505	3.125	9.050	13.469		*
S-4666	3.250	9.789	14.580	✓	*
S-6874	3.500	11.353	16.895	*	*
S-13826	3.625	12.178	18.123		✓
S-11050	3.750	13.033	19.395	*	*
S-8748	3.875	13.916	20.709	✓	
S-6852	4.000	14.828	22.066	*	
S-6860	4.250	16.739	24.910	*	
S-4873	4.500	18.780	27.930	✓	
S-21378	4.750	20.910	31.118	✓	